

akeron

בס"ד



**THE
FLUORESCENT
LUMINAIRES & LIGHTING**

CATALOGUE

This catalogue shows the range of Akeron lighting equipment which is well designed and soundly engineered for use in a variety of applications, in particular, shipboard installations where rattle free robust equipment is necessary.

The twin tube ML types, the single tube EL and CL types plus the miniature MB types available with shaver sockets form a family of fittings with a common design theme to provide continuity of style between general illumination from ceiling or wall and local bed, desk, shelf or mirror lighting.

Shaver socket outlets, when installed in mirror lights are universal and are served through a double wound isolating transformer to BS 3052, providing dual voltage output 115v/230v, and are suitable for use in bathrooms.

For corrosive environments, where the ingress of moisture or dust must be repelled, the GP range of fittings made from self extinguishing GRP and unbreakable polycarbonate are ideal.

Fittings can be supplied to operate from AC supplies in voltages ranging from 110v to 250v 50 Hz or 60 Hz and DC supplies of 6v, 12v and 24v. Please indicate operating voltages when ordering, by completing references as shown on the catalogue pages.

Special fittings can be designed and manufactured by AKERON to meet customers requirements and we will undertake projects to design and develop for individual needs.

Please note all designs and specifications are subject to change without notice. The copyright of this catalogue is vested in akeron (U.K.) Ltd., and it may not be reproduced in whole or part or used for the manufacture of any article without the express permission of the copyright holders.

SPARE COMPONENTS

Voltage & Frequency		CHOKES					
V	Hz	Tube Wattage					
		8	15/20	30	40	65	
110	50	CA8.11.5	CA20.11.5		CA40.11.5		
110	60	CA8.11.6	CA20.11.6		CA40.11.6		
220/230	50	CA8.3.5	CA20.3.5		CA40.3.5	CA65.3.5	
220/230	60	CA8.3.6	CA20.3.6		CA40.3.5	CA65.3.6	
240/250	50	CA8.4.5	CA20.4.5	CA30.4.5	CA40.3.5	CA65.4.5	
240/250	60	CA8.4.6	CA20.4.6		CA40.3.5	CA65.4.6	

Voltage		STARTER SWITCHES					
VOLTAGE		TUBE WATTAGE					
		8	15	20	20	40	65
110		FS2	FS2	FS2		FS40	
200/250		FSU	FS2	FS2	FSU	FSU	FSU

CAPACITORS	
Reference	Circuit
PF35	Single & Tube 20W Single 40W
PF50	Single Tube 65W
PF80	Twin Tube 40W
PF100	Twin Tube 20W 110V

STARTER SOCKETS	
Reference	Luminaire
SL021	All types except MBS8 MBS8
SE18	

LAMP HOLDERS	
Reference	Luminaire
LL305	All sizes except 8W 8W only
LL092	

akeron

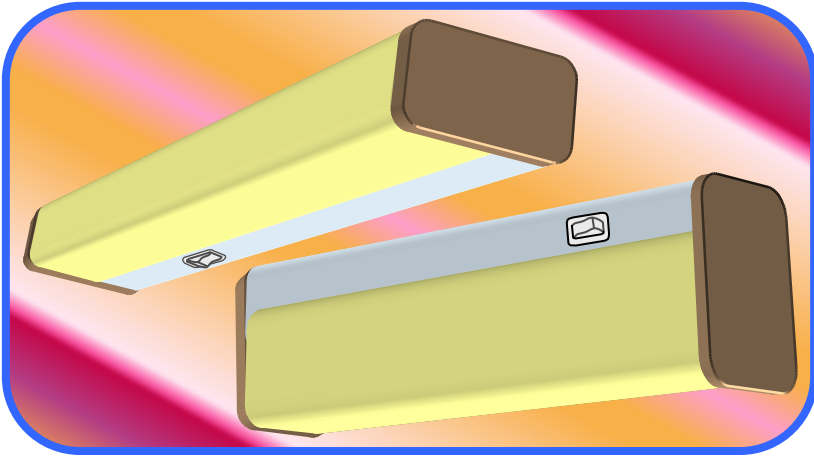

MB Berth mirror desk or shelf light

BODY

Formed from zinc coated sheet steel finished white. End caps are pressed from sheet steel finished mid brown BS 4800 colour 08 B 25 and secured by Chromium plated countersunk pozidrive head screws.

DIFFUSER

Extruded from opal plastic and held securely in position by the end caps. Removal of the diffuser is effected by loosening one end cap screw sufficiently to enable the end cap to be withdrawn to release the diffuser.

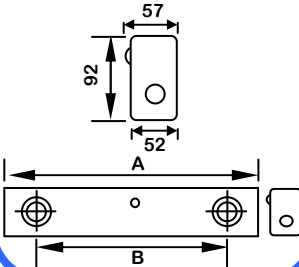

SWITCHES

If ON/OFF switches are required installed on fittings either Double Pole Rocker (R) or Single Pole Pull Cord (W) can be fitted. Please indicate type required by adding identification letter to catalogue reference e.g. MBS8R or MBS8W.

PLEASE NOTE

To comply with IEE regulations only Pull Cord (W) type ON/OFF switches should be employed on fittings installed in bathrooms.

Ref	Watts	A	B	Spare Diffuser
MB8	1x8	318	190	MD12
MB15	1x15	475	400	MD18
MB30	1x30	933	600	MD3
MB40	1x40	1084	600	MD35

SUPPLY VOLTAGE

Fittings are available for operation from supplies other than domestic UK 230V 50 Hz (.4.5) For other voltages please complete reference by adding suffix as table.

AC Supplies			DC Supplies	
Volt	50 Hz	60 Hz	Volts	
240/250	.4.5	.4.6	6	.6
220/230	.3.5	.3.6	12	.12
110/120	.11.5	.11.6	24	.24

e.g.:

MB8 .11.6

Operation from 110V 60 Hz

MB8R .3.6

Operation from 230V DC 60Hz.

akeron

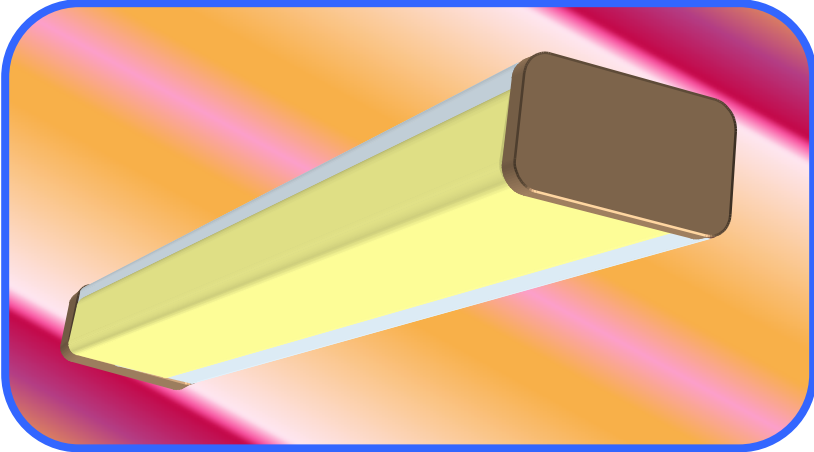

CL Single Tube Corner Luminaire

TOTALLY ENCLOSED DESIGN FOR INTERIOR USE

BODY

Formed from zinc coated sheet steel finished white. End caps are pressed from sheet steel finished mid brown BS 4800 colour 08 B 25 and secured by Chromium plated countersunk pozidrive head screws.

DIFFUSER

Extruded from opal plastic and held securely in position by the end caps. Removal of the diffuser is effected by loosening one end cap screw sufficiently to enable the end cap to be withdrawn to release the diffuser.

MOUNTING

Close ceiling or wall.

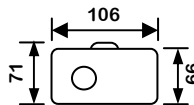
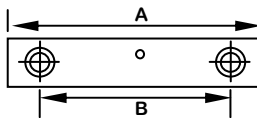

Ref	Watts	A	B	Spare Diffuser
CL20	1x20	630	400	CD2
CL40	1x40	1237	800	CD4

SUPPLY VOLTAGE

Fittings are available for operation from supplies other than domestic UK 230V 50 Hz (.4.5) For other voltages please complete reference by adding suffix as table.

Volt	AC Supplies		DC Supplies	
	50 Hz	60 Hz	Volts	
240/250	.4.5	.4.6	6	.6
220/230	.3.5	.3.6	12	.12
110/120	.11.5	.11.6	24	.24

e.g.:

CL220 .11.6

Operation from 110V 60 Hz

CL220 .12

Operation from 12V DC 60Hz.

akeron

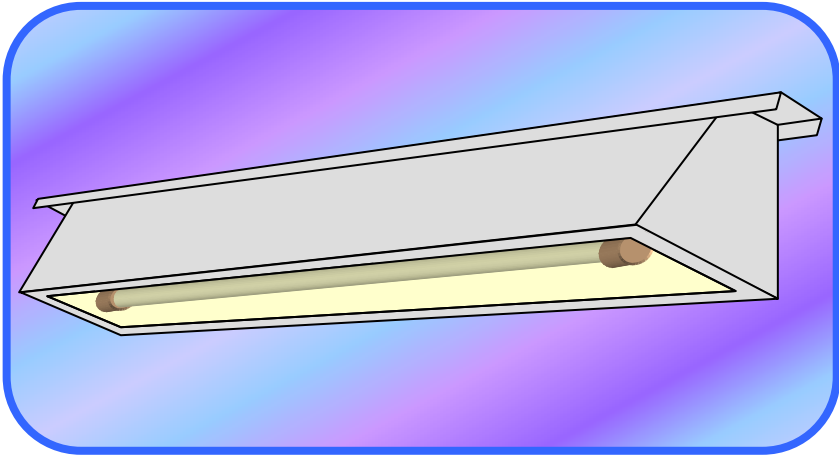

TR Drip-Proof Trough Luminaire

SUITABILITY

The open trough fitting is suitable for all working areas such as Engine Rooms, Stores and Workshops etc.

SUPPLIED

Can be supplied as moisture proof fitting; with lampholder shrouds, gasketed gear housing and sealed ends. It can also be supplied in a less expensive drip proof only version. The metal work is fabricated from Zintec sheet steel primed and stove enamelled white.

LAMPING	CAT. NO.	A	B	WEIGHT KG (LBS)	
SINGLE 2ft 20W	FM6076	724	698	3.85	8.5
SINGLE 4ft 40W	FM6077	1334	1308	4.5	10
SINGLE 2ft 20W	FM6079	724	698	4.2	9.25
SINGLE 4ft 40W	FM6080	1334	1308	5.8	12.8

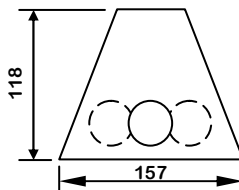
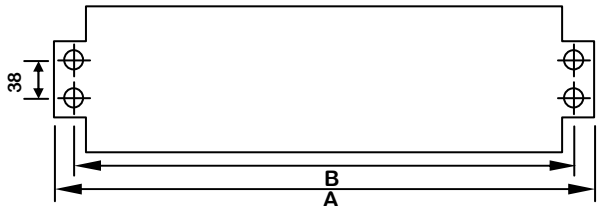

This fitting is wired for 220/230V 60 Hz and incorporates tapping for 200-250 V 50 Hz.

akeron

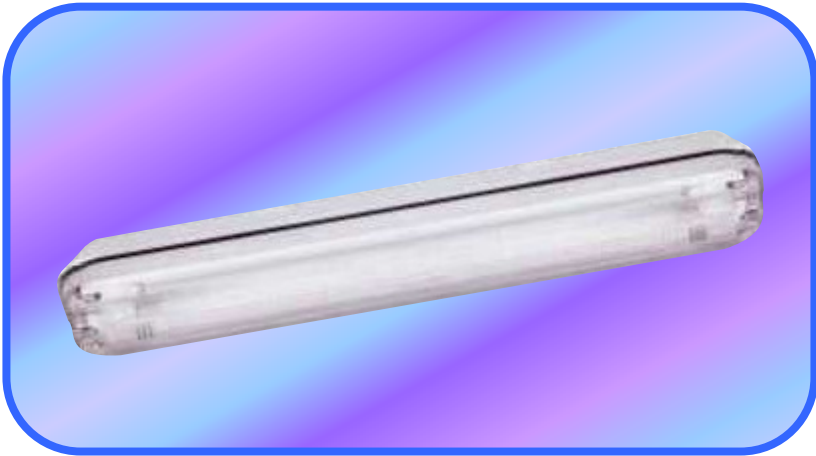

GP Corrosion Resistant Luminaire

TOTALLY ENCILOSED CORROSION RESISTANT MOISTURE & DUSTPROOF LUMINAIRE WITH POLYCARBONATE COVER

BODY

Moulded from self extinguishing grade Glassfibre Reinforced Polyester, moisture, acid and alkali proof. Bushes mounted into the body carry brackets onto which a removable gear tray is mounted and a channel formed around the edge carries a sealing gasket.

COVER

Formed from clear polycarbonate with pebble pattern and held against the sealing gasket with injection moulded polycarbonate fasteners which are captive on the body moulding.

Ref	Watts	A	B	Spare Diffuser
GP20	1x20	670	440	GPD2
GP40	1x40	1280	750	GPD4
GP65	1x65	1580	1050	GPD5
GP220	2x20	670	440	GPD22
GP240	2x40	1280	750	GPD24
GP265	2x65	1580	1050	GPD25

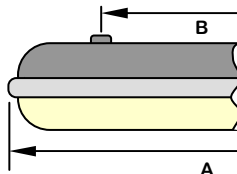
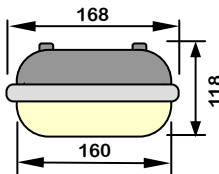
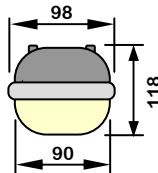

SUPPLY VOLTAGE

Fittings are available for operation from supplies other than domestic UK 230V 50 Hz (.4.5)

For other voltages please complete reference by adding suffix as table.

AC Supplies			DC Supplies	
Volt	50 Hz	60 Hz	Volts	
240/250	.4.5	.4.6	6	.6
220/230	.3.5	.3.6	12	.12
110/120	.11.5	.11.6	24	.24

e.g.:

GP220 .11.6

Operation from 110V 60 Hz

GP220 .12

Operation from 12V DC.

akeron

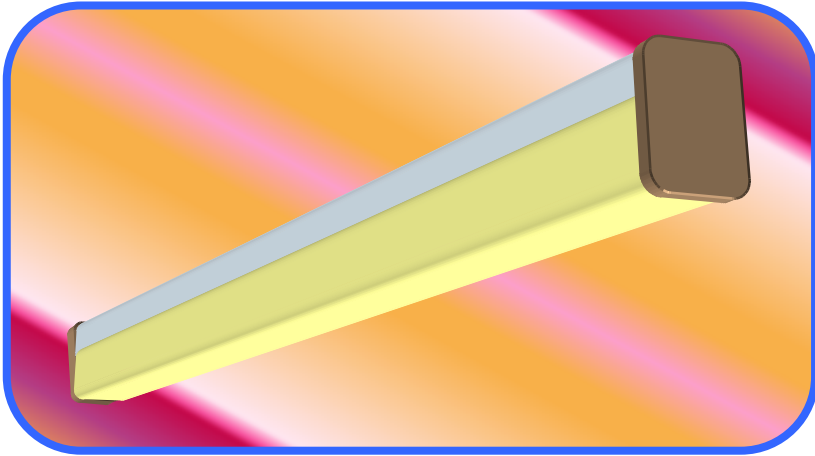

EL Single Tube Luminaire

TOTALLY ENCLOSED DESIGN FOR INTERIOR USE

BODY

Formed from zinc coated sheet steel finished white. End caps are pressed from sheet steel finished mid brown BS 4800 colour 08 B 25 and secured by Chromium plated countersunk pozidrive head screws.

DIFFUSER

Extruded from opal plastic and held securely in position by the end caps. Removal of the diffuser is effected by loosening one end cap screw sufficiently to enable the end cap to be withdrawn to release the diffuser.

MOUNTING

Close ceiling or wall.

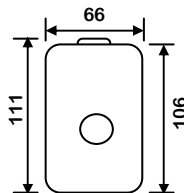
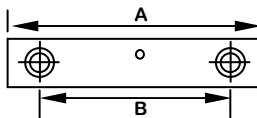

Ref	Watts	A	B	Spare Diffuser
EL20	1x20	630	400	ED2
EL40	1x40	1237	600	ED4
EL40	1x65	1540	600	ED5

SUPPLY VOLTAGE

Fittings are available for operation from supplies other than domestic UK 230V 50 Hz (4.5) For other voltages please complete reference by adding suffix as table.

AC Supplies			DC Supplies	
Volt	50 Hz	60 Hz	Volts	
240/250	.4.5	.4.6	6	.6
220/230	.3.5	.3.6	12	.12
110/120	.11.5	.11.6	24	.24

e.g.:

EL220 .11.6

Operation from 110V 60 Hz

EL220 .12

Operation from 12V DC 60Hz.

akeron

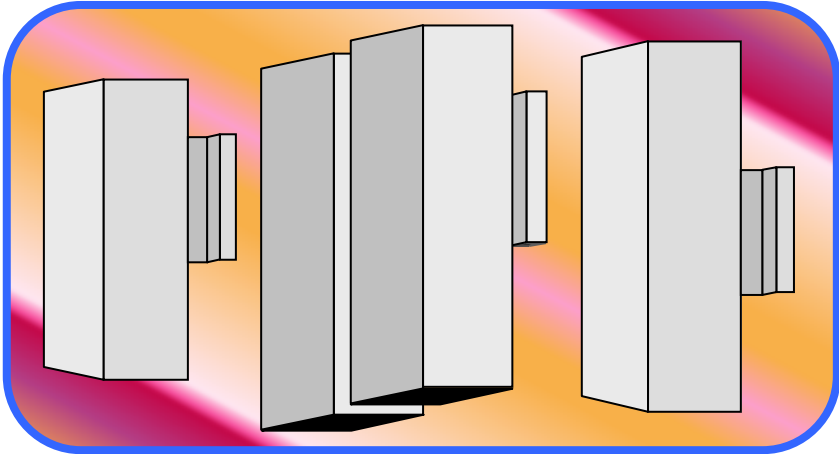

SDL Square Wall Lights

Shown here is the akeron range of dramatic square extruded wall lights.

Three versions are available: Single downlighter, Twin downlighter and a Single up and down lighter.

Type	Cat. Ref.	Lamp:
Single Down	21.126	(ES) 100WISL 100WGLS
Twin Down	21.127	(ES) 100WISL, 100WGLS
Single Up and Down	21.128	(ES) 100WISL, 100WGLS

APPLICATION
Accommodation, Dining
Rooms and Lounges.

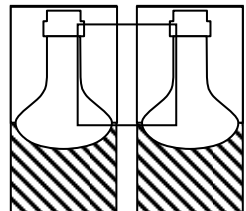
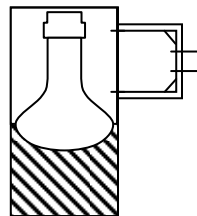
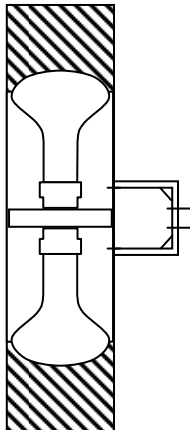

akeron

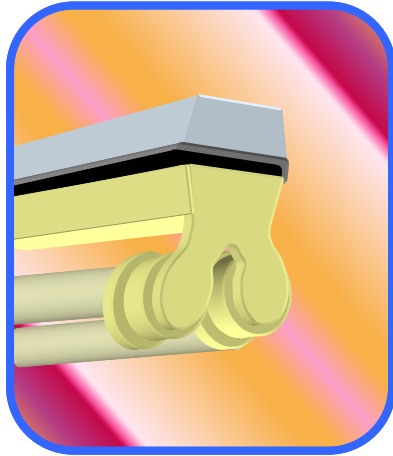
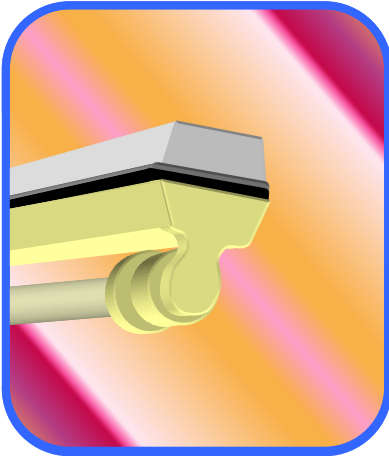

ALW Corrosion Resistant Luminaire

CORROSION RESISTANT

gasketed GRP batten with sealed lampholder.

Single tube		50Hz
Cat. Ref	Watts	Volts
ALW 40	40 watt	240v
ALW 65	65 watt	240v

Twin tube		50Hz
Cat. Ref	Watts	Volts
ALW240	40 watt	240v
ALW265	65 watt	240v

CORROSION RESISTANT

gasketed GRP batten with lamp protecting sleeves & sealed lampholder.

Single tube		50Hz
Cat. Ref	Watts	Volts
ALWS 40	40 watt	240v
ALWS 65	65 watt	240v

Twin tube		50Hz
Cat. Ref	Watts	Volts
ALWS240	40 watt	240v
ALWS265	65 watt	240v

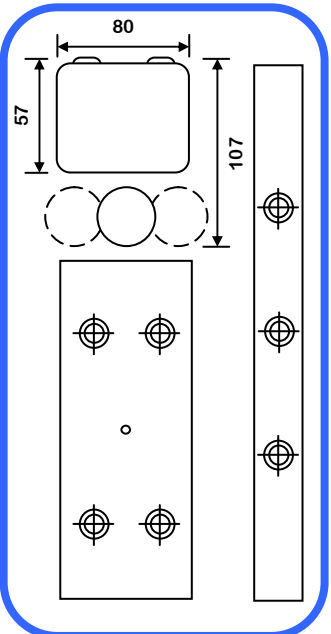

akeron

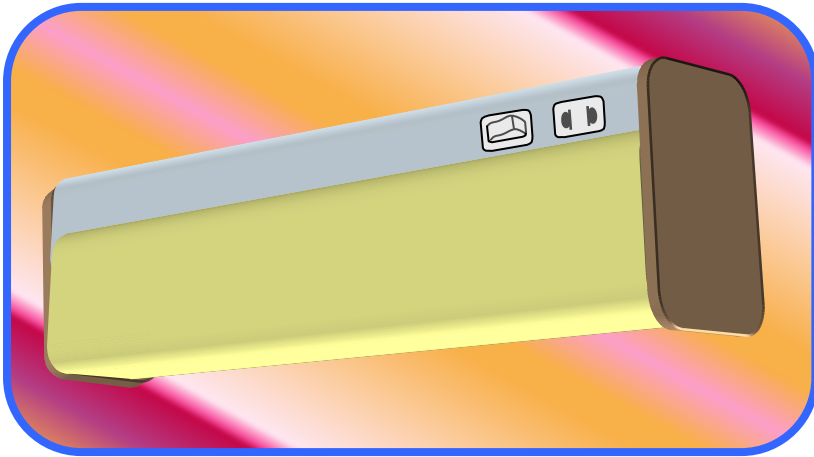

MBS Berth mirror light with shaver socket

BODY

Formed from zinc coated sheet steel finished white. End caps are pressed from sheet steel finished mid brown BS 4800 colour 08 B 25 and secured by Chromium plated countersunk pozidrive head screws.

DIFFUSER

Extruded from opal plastic and held securely in position by the end caps. Removal of the diffuser is effected by loosening one end cap screw sufficiently to enable the end cap to be withdrawn to release the diffuser.

Ref	Watts	A	B	Spare Diffuser
MBS8	1x8	318	190	MD12
MBS15	1x15	475	400	MD18
MBS30	1x30	933	600	MD3
MBS40	1x40	1084	600	MD35

SWITCHES

If ON/OFF switches are required installed on fittings either Double Pole Rocker (R) or Single Pole Pull Cord (W) can be fitted.

Please indicate type required by adding identification letter to catalogue reference e.g. MBS8R or MBS8W.

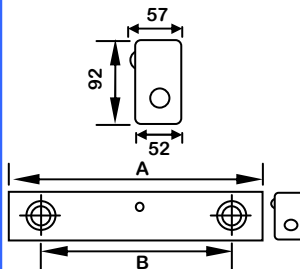

PLEASE NOTE

To comply with IEE regulations only Pull Cord (W) type ON/OFF switches should be employed on fittings installed in bathrooms.

SUPPLY VOLTAGE

Fittings are available for operation from supplies other than domestic UK 230V 50 Hz (.4.5) For other voltages please complete reference by adding suffix as table.

AC Supplies		
Volt	50 Hz	60 Hz
240/250	.4.5	.4.6
220/230	.3.5	.3.6

e.g.:

MBSW15 .4.6

15 Watt fitting with pull switch for 240V 60Hz.

akeron

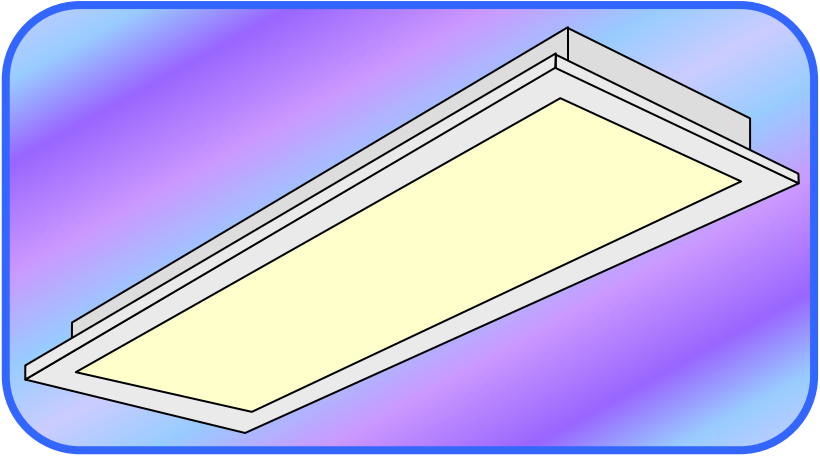

SN Recessed Luminaire FOR INTERIOR USE

BODY

Formed from zinc coated sheet steel finished white. End caps are pressed from sheet steel finished mid brown BS 4800 colour 08 B 25 and secured by Chromium plated countersunk pozidrive head screws.

DIFFUSER

Opal plastic dish retained in front frame

Ref	Watts	A	B	Spare Diffuser
SN20	1x20	620	655	SND24/A
SN220	2x20	620	655	SND24/A
SN40	1x40	1230	1265	SND24/A
SN240	2x40	1230	1265	SND24/A

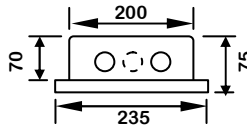
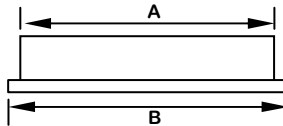

SUPPLY VOLTAGE

Fittings are available for operation from supplies other than domestic UK 230V 50 Hz (.4.5)

For other voltages please complete reference by adding suffix as table.

AC Supplies			DC Supplies	
Volt	50 Hz	60 Hz	Volts	
240/250	.4.5	.4.6	6	.6
220/230	.3.5	.3.6	12	.12
110/120	.11.5	.11.6	24	.24

e.g.:

SN220 .11.6

Operation from 110V 60 Hz

SN220 .12

Operation from 12V DC.

akeron

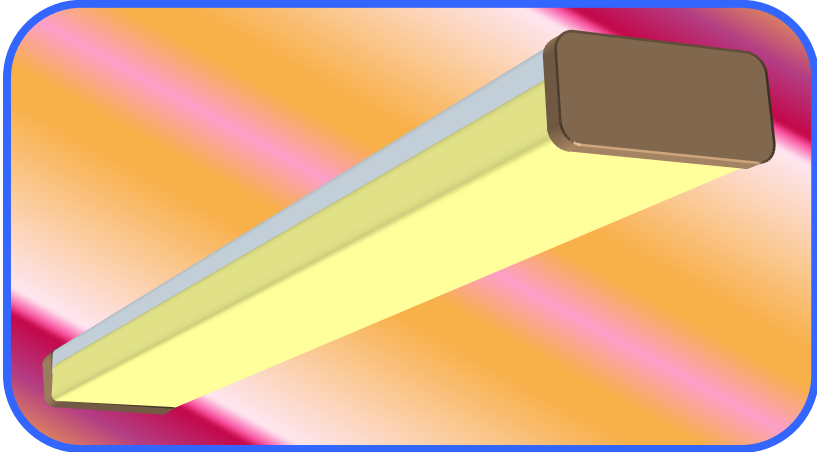

ML Twin Tube Luminaire

TOTALLY ENCLOSED DESIGN FOR INTERIOR USE

BODY

Formed from zinc coated sheet steel finished white. End caps are pressed from sheet steel finished mid brown BS 4800 colour 08 B 25 and secured by Chromium plated countersunk pozidrive head screws.

DIFFUSER

Extruded from opal plastic and held securely in position by the end caps. Removal of the diffuser is effected by loosening one end cap screw sufficiently to enable the end cap to be withdrawn to release the diffuser.

MOUNTING

Close ceiling or wall.

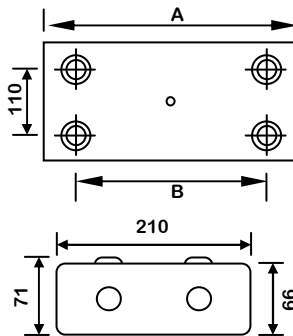

Ref	Watts	A	B	Spare Diffuser
ML20	2x20	630	400	MD22
ML40	2x40	1237	800	MD24

SUPPLY VOLTAGE

Fittings are available for operation from supplies other than domestic UK 230V 50 Hz (.4.5) For other voltages please complete reference by adding suffix as table.

Volt	AC Supplies		DC Supplies	
	50 Hz	60 Hz	Volts	
240/250	.4.5	.4.6	6	.6
220/230	.3.5	.3.6	12	.12
110/120	.11.5	.11.6	24	.24

e.g.:

ML220 .11.6

Operation from 110V 60 Hz

ML220 .12

Operation from 12V DC 60Hz.

The akeron range of square cell louvre panels

Of the interesting and decorative variety of louvre diffuser designs and arrangements, the square cell (or egg crate) configuration provides a neat appearance and an even diffusion of light without glare, at more economical cost than for the more elaborate louvre designs among these pages.

STYRENE FINISHES: Opal, silver, copper and gold

ALUMINIUM FINISHES: Natural, white, satin, matt and silver

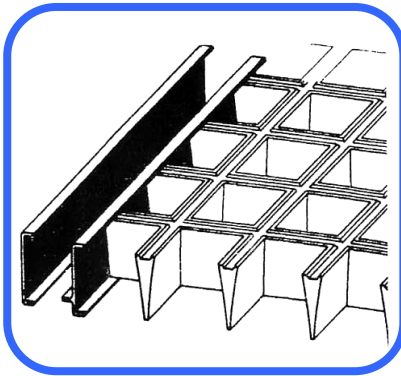
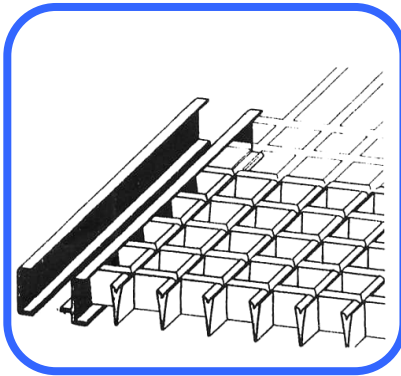

PANEL SIZES

Normally Available
603 mm x 1206 mm
604 mm x 1208 mm
600 mm x 1240 mm
1800 mm x 600 mm
1200 mm x 1200 mm

CELL SIZES

20 x 20 x 19 mm
38 x 38 x 25 mm
60 x 60 x 40 mm
20 x 20 x 13 mm
16 x 16 x 13 mm

Standard Diffusers for the akeron range of luminaires

DIFFUSER REFERENCE		USED WITH FITTING	
ED.2	EL.20	Single Tube Luminaire	20 Watts
ED.4	EL.40	Single Tube Luminaire	40 Watts
ED.5	EL.60	Single Tube Luminaire	65 Watts
MD.22	ML.220	Twin Tube Luminaire	2x20 Watts
MD.24	ML.240	Twin Tube Luminaire	2x40 Watts
MD.25	ML.265	Twin Tube Luminaire	2x65 Watts
MD.12	MBS. 8 & MB.8	Berth/Mirror/Desk	1x8 Watts
MD.18	MBS. 15 & MB.15	Berth/Mirror/Desk	1x15 Watts
MD.3	MBS. 30 & MB.30	Berth/Mirror/Desk	1x30 Watts
MD.35	MBS. 40 & MB.40	Berth/Mirror/Desk	1x40 Watts
The 'S' suffix denotes integral shaver socket.			
CD.2	CL.20	Corner Luminaire	1x20 Watts
CD.4	CL.40	Corner Luminaire	1x40 Watts
GP.2	GP.20	Corrosion Resistant With Polycarbonate Diffuser	
GP.4	GP.40		1x20 Watts
GP.5	GP.65		1x40 Watts
GP.22	GP.220		1x65 Watts
GP.24	GP.240		2x20 Watts
GP.25	GP.265		2x40 Watts
			2x65 Watts

The Akeron diffuser replacement service involves not only our own makes, but also any other make or style of diffuser against a customer sample or drawing. The fittings referred to are described with: specification, drawings and pictorial information in a separate Akeron brochure available on request.

Fluorescent Lighting Fittings And Diffusers

“Well designed and soundly engineered”

A family of fittings in a variety of sizes and configurations for:

CEILINGS, DESKS, WALL, CABIN, BATHROOM, COMMERCIAL OFFICES, WAREHOUSES, GARAGE, PUBLIC BUILDINGS, PASSENGER AND FREIGHT SHIPS, LEISURE AND SPORT COMPLEXES, OIL PLATFORMS, FACTORIES, HIGH TEMPERATURE AREAS, (BOILER AND ENGINE ROOMS ETC.)

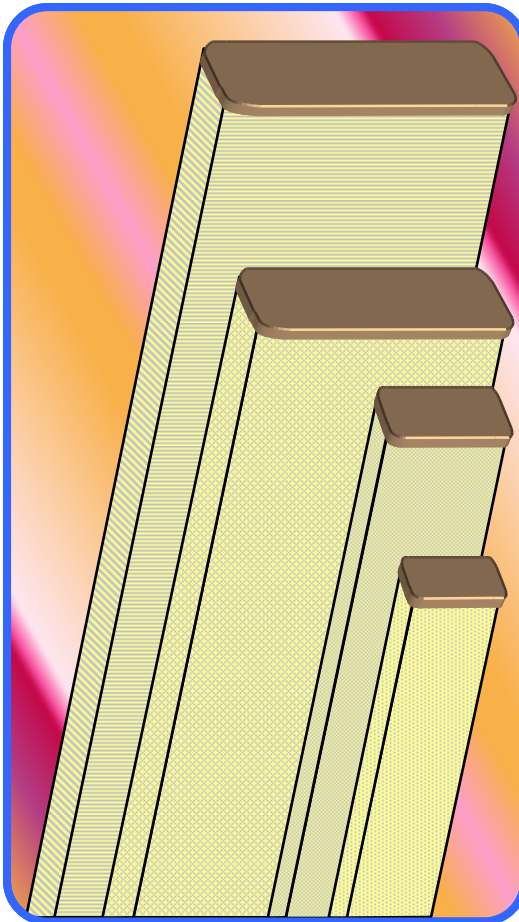

With or without emergency module – which takes over when main power fails – to provide continuity of light for at least another three hours.

Recreate the original pristine appearance, and comfortable light level. Without incurring the expense of replacing the entire fitting by calling upon the akeron

Diffuser Replacement Service

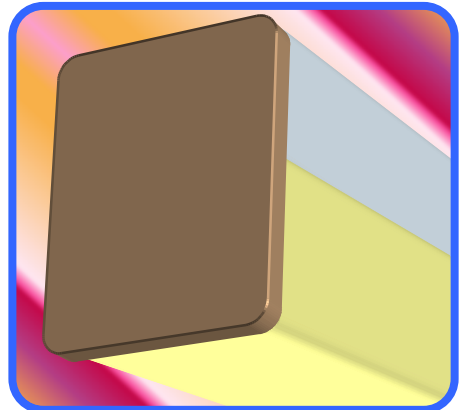

akeron



PROBLEM SOLVER

H. Fabrications in Stainless Steel, aluminium, brass, copper, mild steel etc. - For builders, kitchens, stations, hospitals etc.

A. Special bolts including 'J' & 'U' bolts, brackets, and fixtures of all kinds in plastics and metals.

B. Ashtrays, Wastebins, Floor/Wall Cigarette Disposal Stations, Fire Safety Bins & Ashtrays. E.g. The famous 'Honeycomb Ashtray'

G. Lighting Diffuser shades in plastics - Aluminium Louvres - replacements - Marine and commercial. Plastic Fabrication & Sheeting. DIFFUSER REPLACEMENT SERVICE

C. Fluorescent Lighting. Standard & to customer specification interior & exterior Mirror Light with Shaver Socket Emergency Lighting

F. Component sourcing & identification / redesign. Prototyping. Mechanical & Electronic Draughting.

E. Hourglasses - an elegant time piece, beautiful ornament, corporate award, wedding / retirement gift, executive toy.

D. Bar Supplies & Fittings bottle openers / cork catchers. Cash boxes, bank note scanners. Hotel & Catering Supplies. Signs, Menus.

Akeron (UK) Ltd., 15 Terminal Close, Shoeburyness, Essex. SS3 9BN.

Tel: +44 (0) 1702 297101

Fax: +44 (0) 1702 297101

akeron@talktalkbusiness.net

<http://www.akeron-uk.com>